



Standard Operating Procedure

Manual Override Procedure

MEGA LIFT - Quick Guide Manual



INTENDED USE

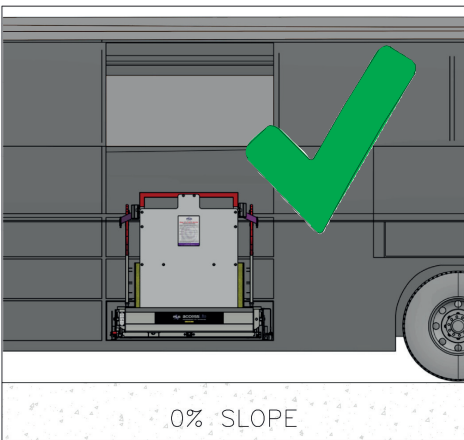
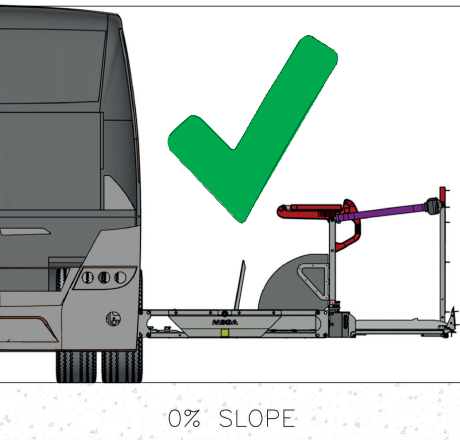

IMPROPER USE

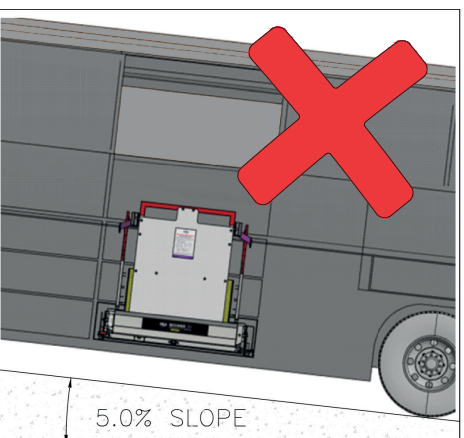
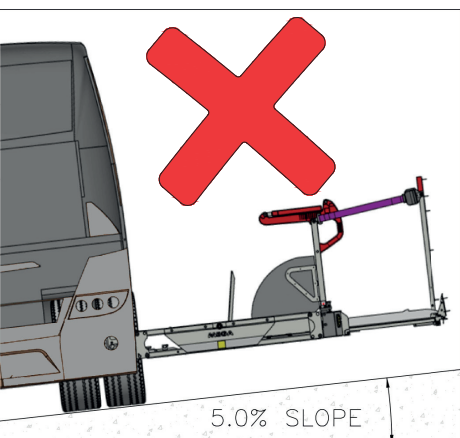

SAFETY DEVICES (*RECOMMENDED OPTIONS)

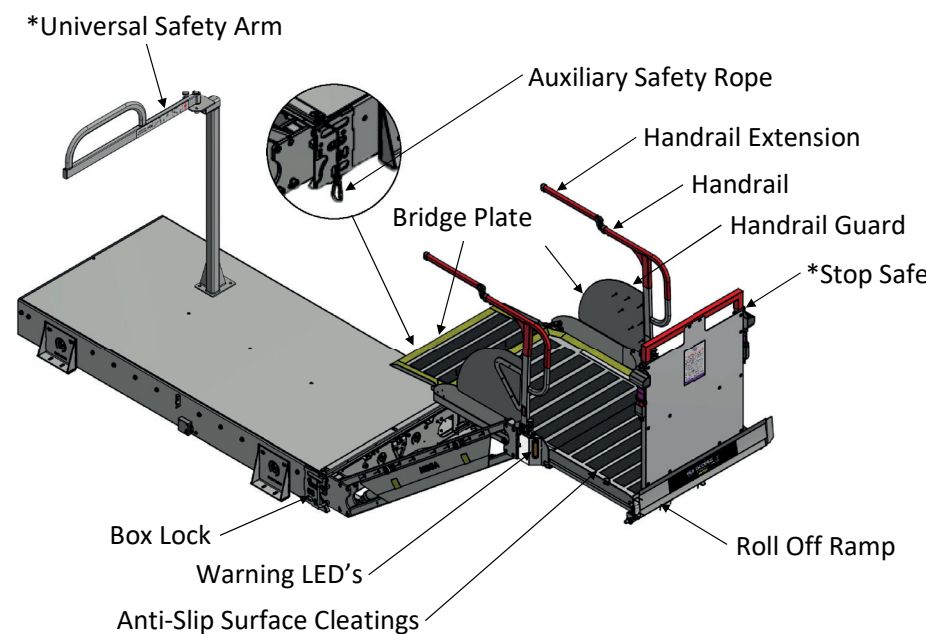

PASSENGER LOADING OPTION 1

Operator
Passenger

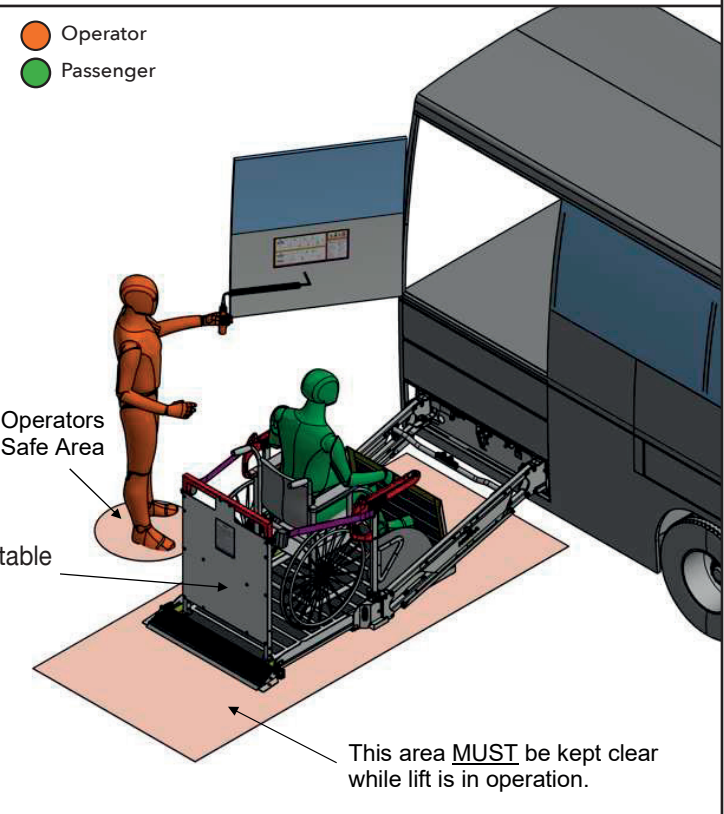

HANDSET CLIP LOCATION

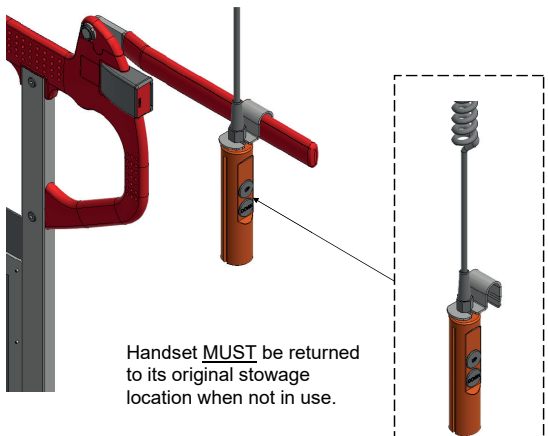

LIFT ISOLATOR

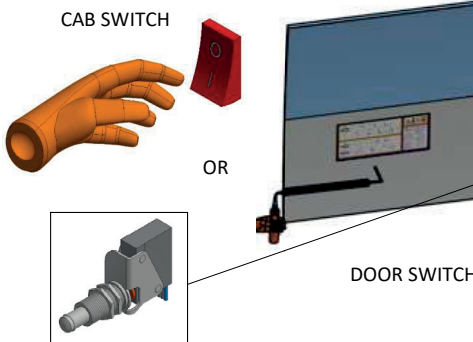

PASSENGER LOADING OPTION 2

Operator
Passenger

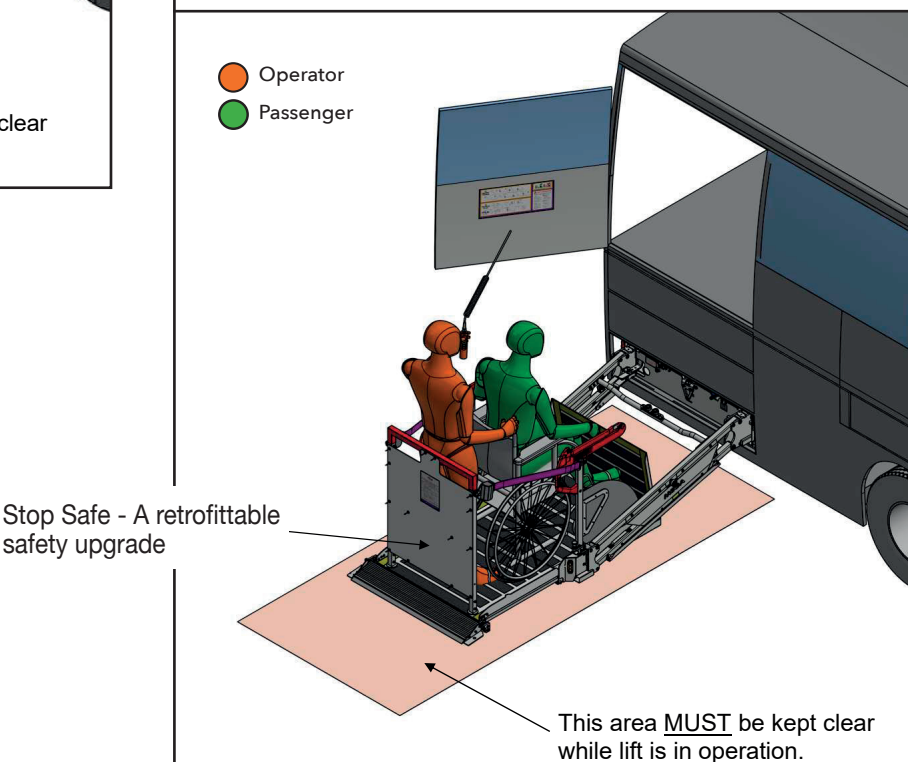

- The platform lift is a mechanical device controlled by a hydraulic/electrical system that enables passengers to be elevated safely from the ground into the vehicle.
- The lift must be operated by fully trained and competent operators.
- Suitable lighting **MUST** be provided to enable the operator to use the lift safely.
- The emission sound when the lift is in operation should not exceed 80dB.
- It is the operator's responsibility to ensure that all safety features fitted are used appropriately and that all safety warning devices, safety labels/ information is/are present and correctly displayed at all times.